



501 (c) (6) Non-Profit Corporation

# Candidates & Issues Forum

The Clark County Chamber of Commerce and Partner Organizations are pleased to present our annual Candidates & Issues Forum. This is a unique opportunity to hear and speak with candidates for key leadership positions as well as to hear about issues affecting the future of Clark County and the State of Washington. There will also be a question and answer session.

- When: 7:00 - 9:00 a.m.  
Tuesday, October 11, 2005
- Where: Summit Grove Lodge  
30810 NE Timmen Rd  
Ridgefield, WA 98642 <sup>[1]</sup>
- Admission: Free and open to the public
- Services: Refreshments provided (RSVP by 10/10)
- Topic: Candidates & Issues Forum
- Moderator: Greg Kimsey, Clark County Auditor

For more information and to RSVP, please contact your Chamber at 360-258-1181 or email [info@ClarkChamber.com](mailto:info@ClarkChamber.com)

*Your County-Wide  
Business Connection*

- Visibility*
- +
- Networking*
- +
- Public Advocacy*
- +
- Business Services*
- +
- Training Programs*

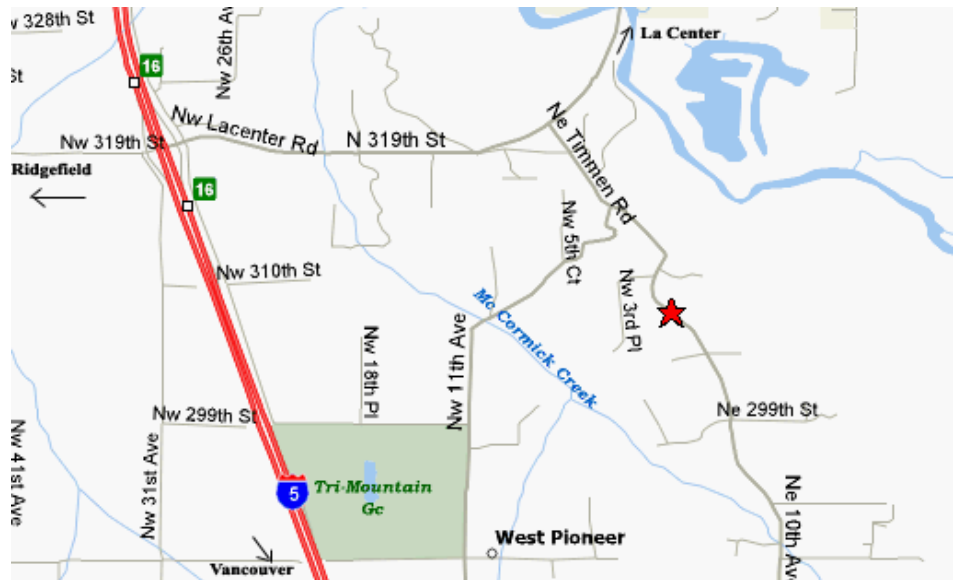

<sup>[1]</sup>Directions: Take I-5 North, Exit 16 (La Center Rd), turn East to LaCenter, turn right on NE Timmen Rd., Summit Grove Lodge is approximately one mile on the right side of NE Timmen Road.

[www.ClarkChamber.com](http://www.ClarkChamber.com)  
[info@ClarkChamber.com](mailto:info@ClarkChamber.com)

360-258-1181 Main  
360-838-6604 Fax

P.O. Box 2947  
Vancouver, WA 98668